

Dimensions

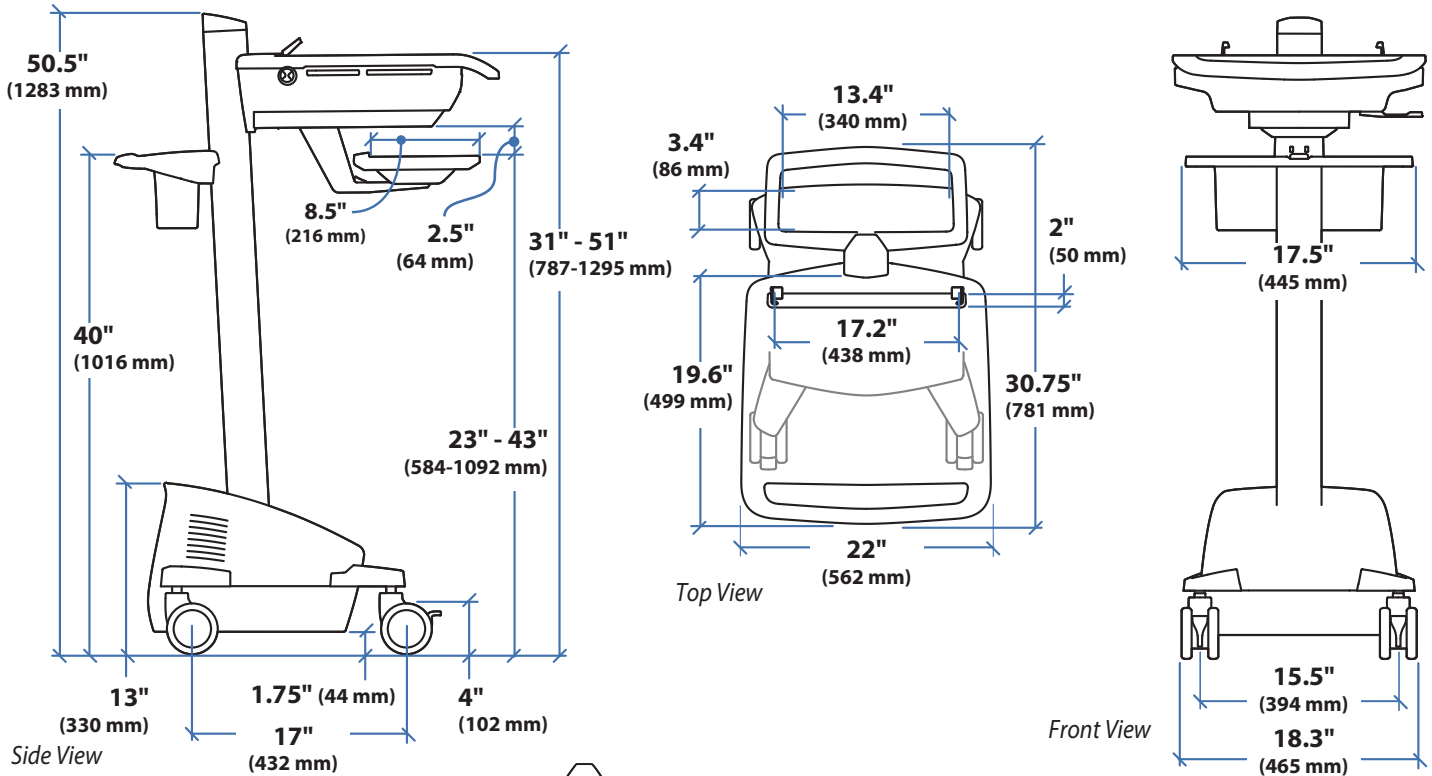

Laptop Compartment

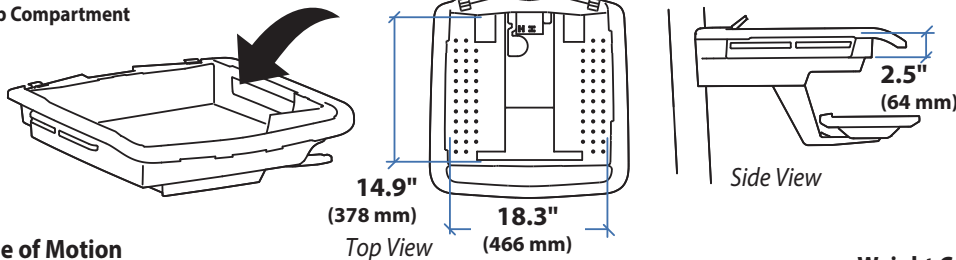

When figuring dimensions, include mounted accessories, protruding cables and port replicators or docking stations.

Range of Motion

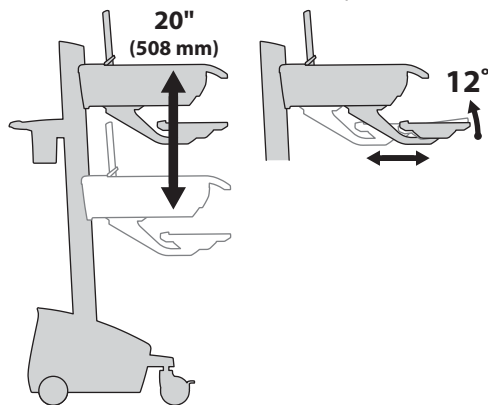

Weight Capacity

- Open Worksurface: 0 lbs (0 kg)
- Closed Worksurface: <5 lbs (2.3 kg)
- CPU Compartment: <10 lbs (4.5 kg)

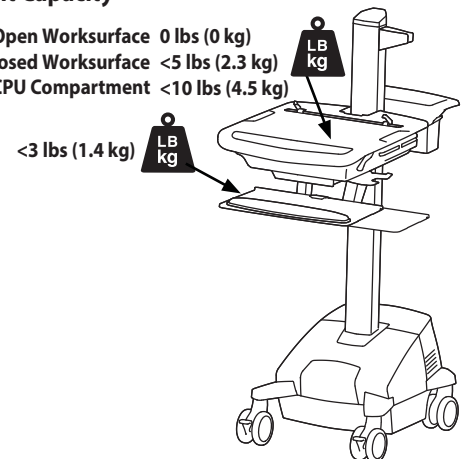

© 2014 Ergotron, Inc. rev. 03/28/2022 DIM-SV42Laptop Content is subject to change without notification

Americas Sales and Corporate Headquarter

St. Paul, MN USA
(800) 888-8458
+1-651-681-7600
www.ergotron.com
insidesales@ergotron.com

EMEA Sales

Amersfoort, The Netherlands
+31 33 45 45 600
www.ergotron.com
info.eu@ergotron.com

APAC Sales

Sydney, Australia
www.ergotron.com
apacustomerservice@ergotron.com

Worldwide OEM Sales

www.ergotron.com
info.oem@ergotron.com